

160.4400 | Concealed 2-Way Thermostatic Diverter

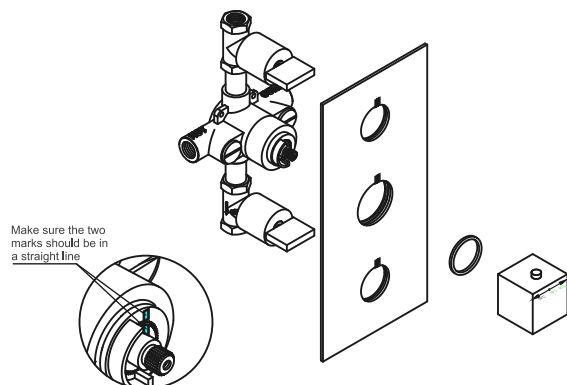

SPECIFICATIONS:

- Solid Brass construction - includes valve
- 49 LPM Flow Rate at 3 BAR
- Diverter controls water flow between 2 outlets
- Ceramic disc cartridge allows both volume and temperature control

FINISHES :

- Chrome - 160.4400

STANDARDS:

- ASME A112.18.1 / CSA B125.1, NSF-61

LowFlow Capable



Legislation Compliance



ZeroDrip Technology



Belgian Mirror Finish



Technical Diagram

